



*A unique mix of Creole elegance and functionality :  
a hotel dedicated to business tourism*



Meeting guide



## Site

A seaside hotel located on the Caribbean coast, surrounded by 12,5 acres of private tropical park.

## Rooms

193 rooms distributed in 2 buildings overlooking the sea.

4 handicapped access rooms - 5 duplex - 3 suites - 16 deluxe rooms  
- 97 superior rooms and 68 standard rooms.

Terraces with a view to the sea or the park, Creole furniture, silent air conditioning, direct international telephone access, French and English channels, individual safe, mini-bar - Bathroom decorated with marble (non standard) equipped with both a shower and a bathtub, hair drier, telephone, magnifying mirror with razor

## Restaurants

Poolside restaurant and bar, the "Bleu Marine"

American buffet breakfast - Creole and international cuisine, live music, themed evenings (folkloric ballets)

Piano bar in the hall, the "West Indies Bar"

## Meetings & Banquets

A very large and flexible room which can accommodate up to 600 guests, and which can be converted into 4 separate meeting rooms (fully equipped with sound system and other professional equipment), extended by a semi-covered immense terrace with a direct view to the sea and the swimming pool.

A meeting room, amphitheatre shaped and a separate sub-committee room.

## Leisure activities

Outside fresh water pool - All equipped white sand beach (beach chairs, shower, bathroom, fresh drink service), with a private wharf.

Nautical base (windsurfing, kayaking, scuba diving) - 6 tennis courts

A casino (next door) - An 18 hole golf course 40 km away in the village of Trois-Ilets

## Wellness

A fitness room and a hairdresser.

## Services

Car rental desk, two outside parking lots, one excursion desk, shopping arcade, business center.



Map designed specifically by Catherine Théodose for La Batelière Hotel

## Location

Located in the centre of Martinique, halfway between the capital, Fort-de-France and the city of Schoelcher (respectively, 3 and 2 km away), with a direct access on the highway leading to the airport (15 km away), La Batelière Hotel has a privileged location.

Whether for leisure or for business, this exceptional location will allow you to get the best of your stay.



## Level 1 - Business

1	Parking
2	Main entrance
3	Lobby
4	Bar West-Indies
5	Terrace
6	Sapotille room
7	Tamarin room
8	Corossol room
9	Lafitte room
10	Auditorium room
11	Panoramique room

## Level 0 - Leisure

Shopping arcade
Fitness room
"Bleu Marine" Restaurant
Swimming pool
Access to the beach

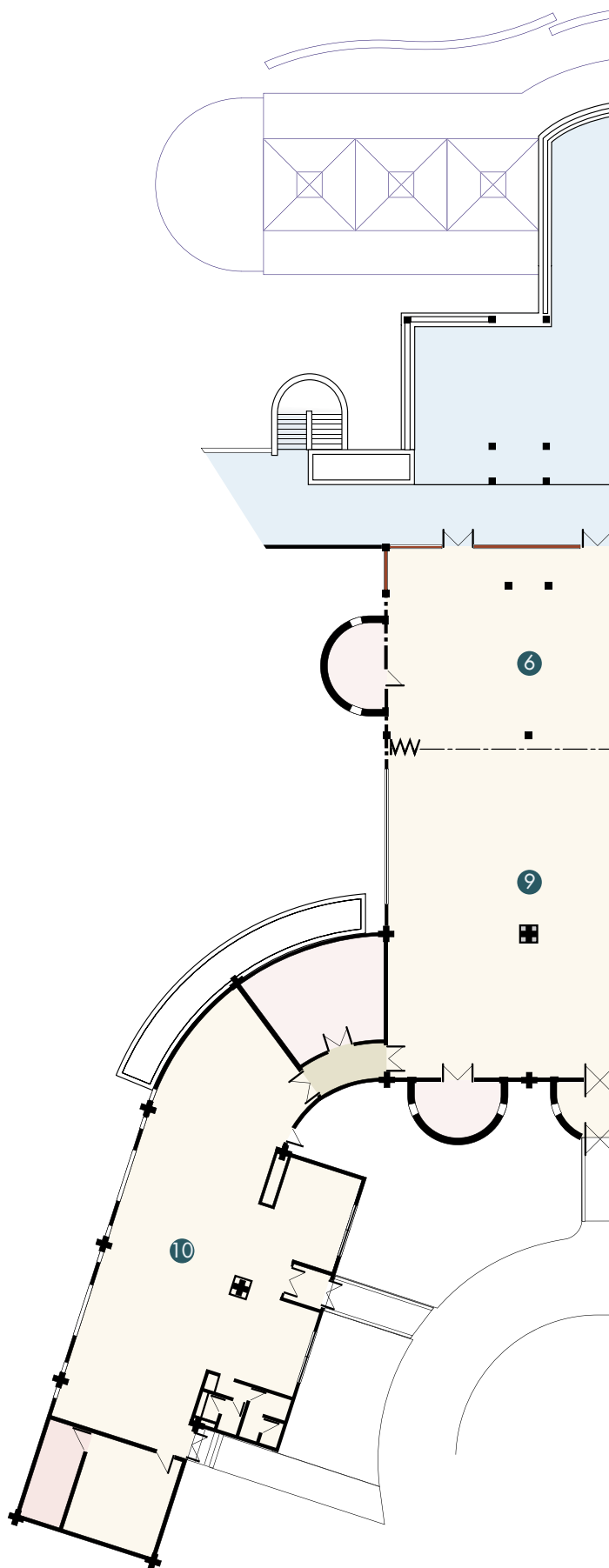

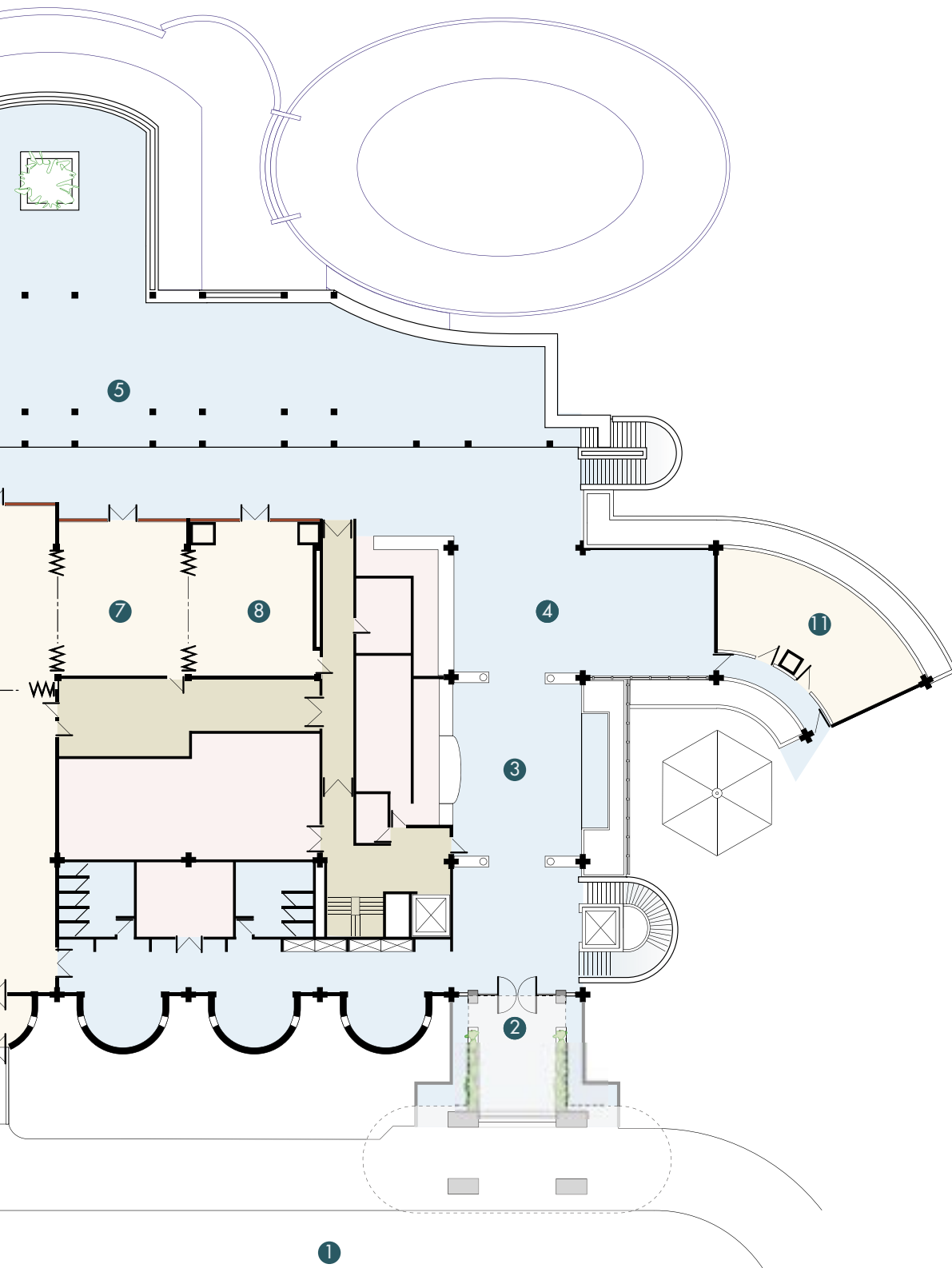





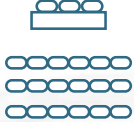

## Capacity for each meeting room - Summary

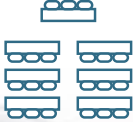

	Rooms	Surfaces					
9	Lafitte	255 m <sup>2</sup>	280	120	200	200	250
6	Sapotille	182 m <sup>2</sup>	180	80	150	150	190
7	Tamarin	67 m <sup>2</sup>	60	25	50	55	80
8	Corossol	68 m <sup>2</sup>	60	25	50	55	80
	<b>All together</b>	<b>572 m<sup>2</sup></b>	<b>500</b>	<b>-</b>	<b>350</b>	<b>450</b>	<b>550</b>
5	Terrasse	403 m <sup>2</sup>	280	120	200	200	400
10	Auditorium	200 m <sup>2</sup>	200		100	-	200
11	Panoramique	75 m <sup>2</sup>	70	30	-	35	70

The following capacities are given for information only, they change according to your set up.

For buffets, the maximum capacity is 15% inferior to the capacity indicated for a banquet. Our services remain at your disposal for any special request.

To organize a special event or evening, we can refer you to our partners, including for the management of groups (hostesses, hosts, presenters, models, extras, photographers...), for reception purposes (VIP, booths) or for the complete management of your event.





# Lafitte Room



## Information

Surface (2745 sq.ft)	255 m <sup>2</sup>
Height	3,00

## Capacity

Theater style	280
Classroom style	200
U-shapped	120
Cocktails	250
Banquets*	200

## Miscellaneous

- Electrical screens
- Communicating
- Exterior & interior access
- Garden view

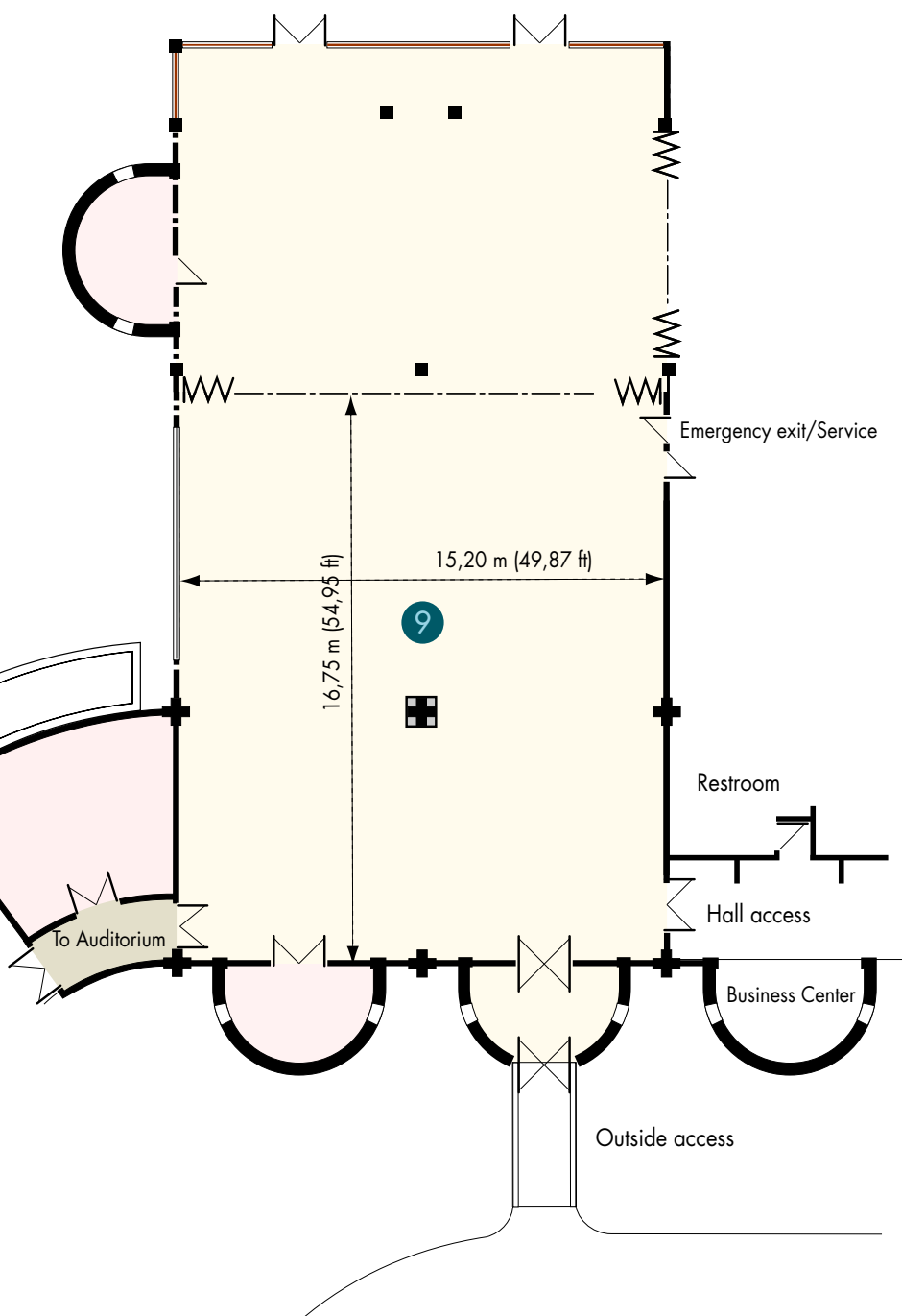



# Sapotille Room

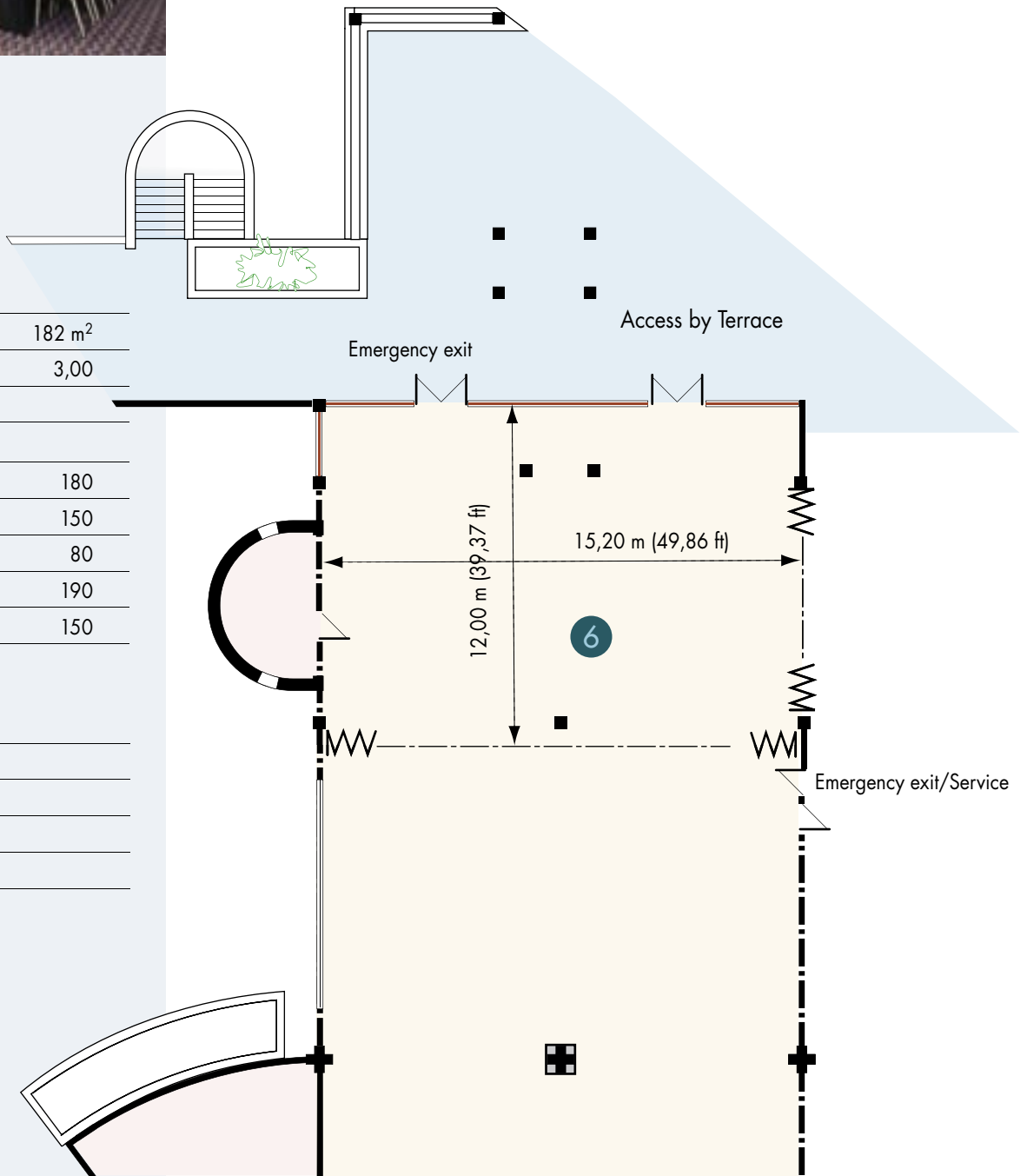

## Information

Surface (1959 sq.ft)	182 m <sup>2</sup>
Height	3,00

## Capacity

Theater style	180
Classroom style	150
U-shapped style	80
Cocktails	190
Banquets*	150

## Miscellaneous

Electrical screens	
Communicating	
Hall access	
Direct terrace access	





# Tamarin Room

# Corossol Room



### Information

Surface (721 sq.ft)	67 m <sup>2</sup>
Height	3,00

### Capacity

Theater style	60
Classroom style	50
U-shaped style	25
Cocktails	80
Banquets*	55

### Miscellaneous

Electrical screen	
Hall access	
Direct terrace access	

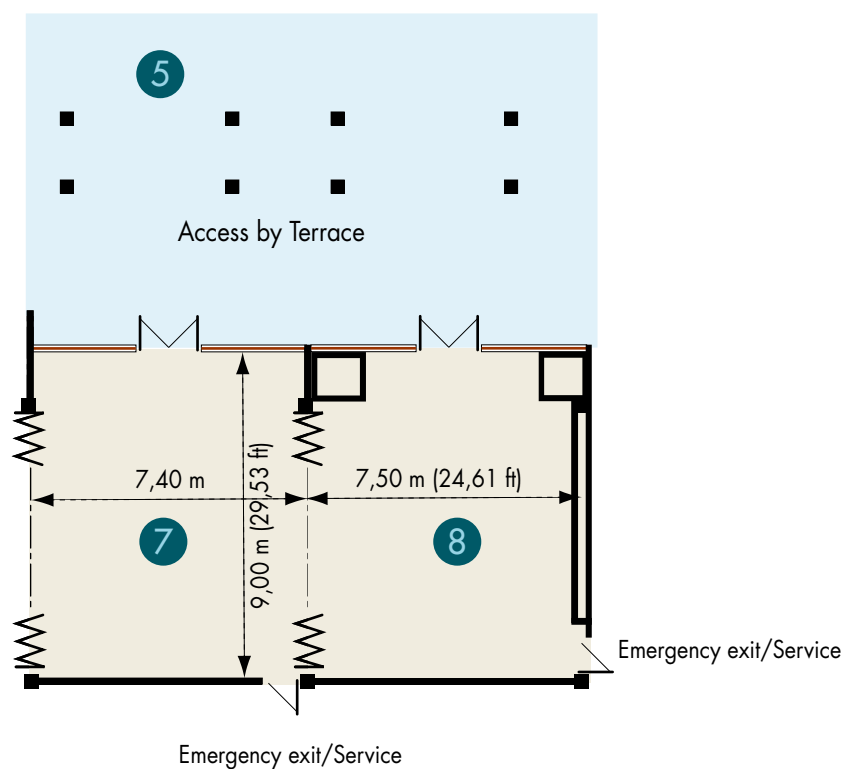



# Rooms Together

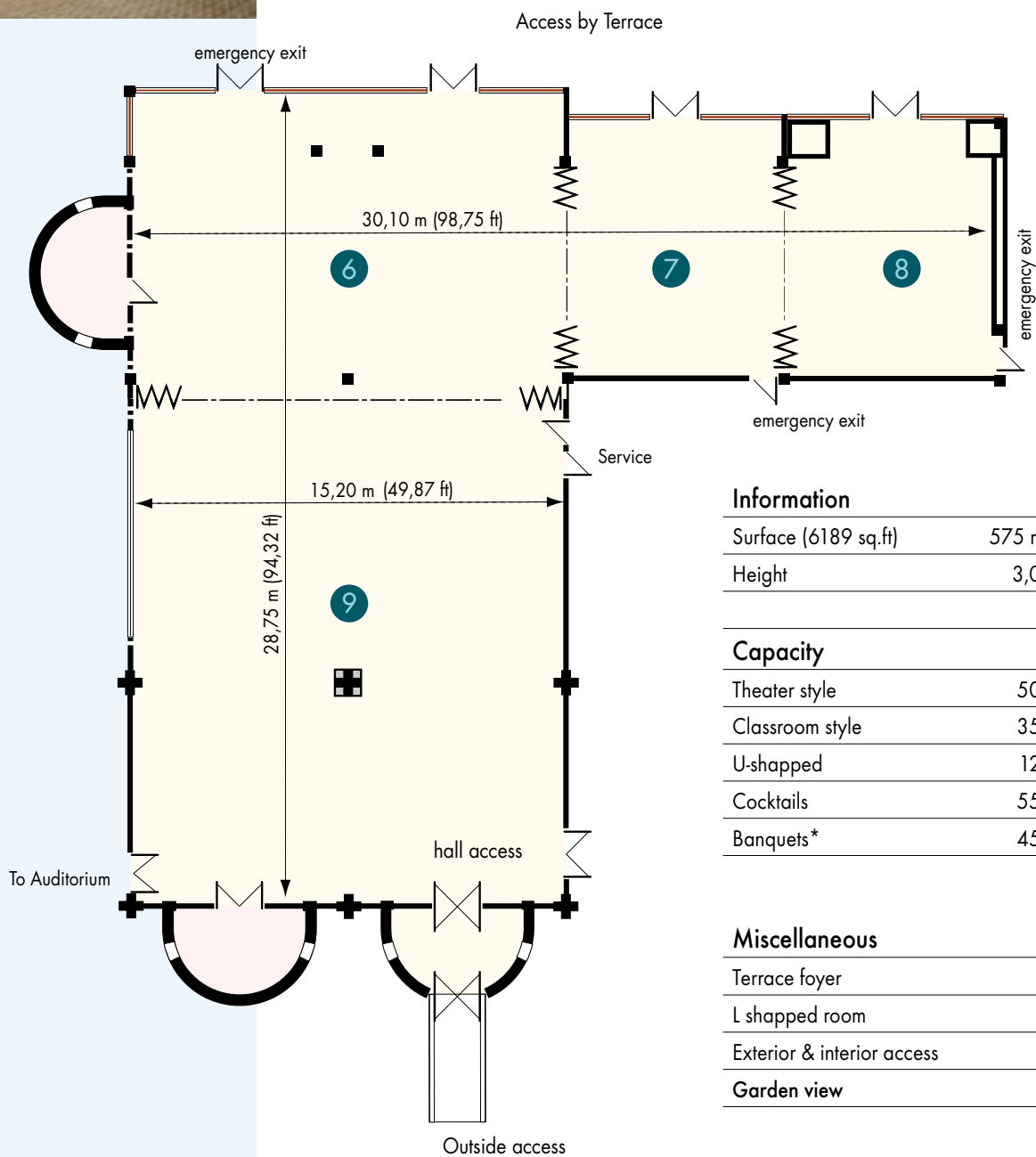

### Information

Surface (6189 sq.ft)	575 m <sup>2</sup>
Height	3,00

### Capacity

Theater style	500
Classroom style	350
U-shaped	120
Cocktails	550
Banquets*	450

### Miscellaneous

Terrace foyer
L shaped room
Exterior & interior access
Garden view



# Terrace



## Information

Surface (4338 sq.ft)	403 m <sup>2</sup>
Height	2,80

## Capacity

Theater style	280
Classroom style	200
U-shapped	120
Cocktails	400
Banquets*	200

## Miscellaneous

Sea view

Open room

Half uncovered

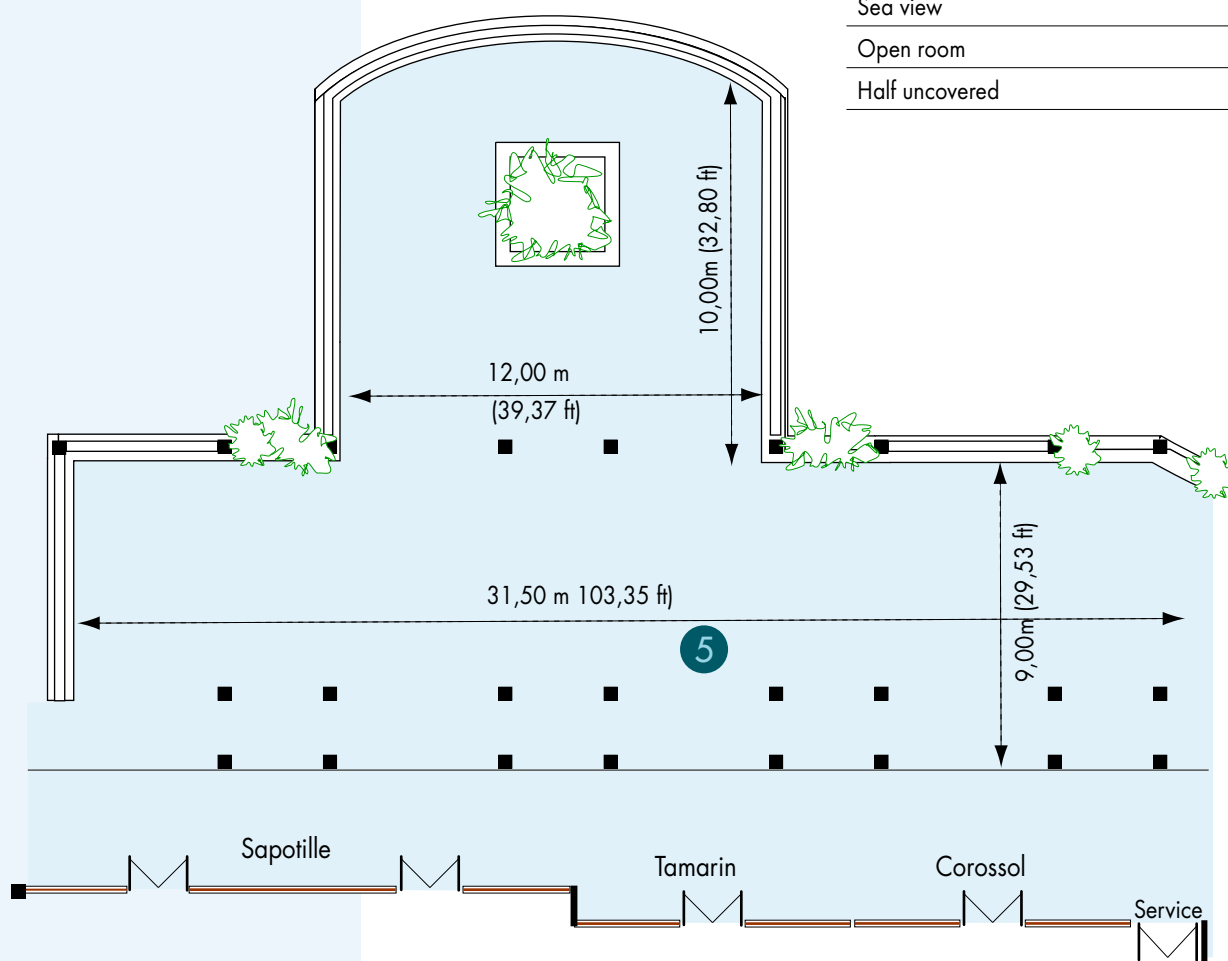



# Auditorium



## Information

Surface (2153 sq.ft)	200 m <sup>2</sup>
Height	5,00

## Capacity

Theater style	200
Classroom style	100
Cocktails	200

## Miscellaneous

Dressing room
Small bar
Restroom
Direct access from outside

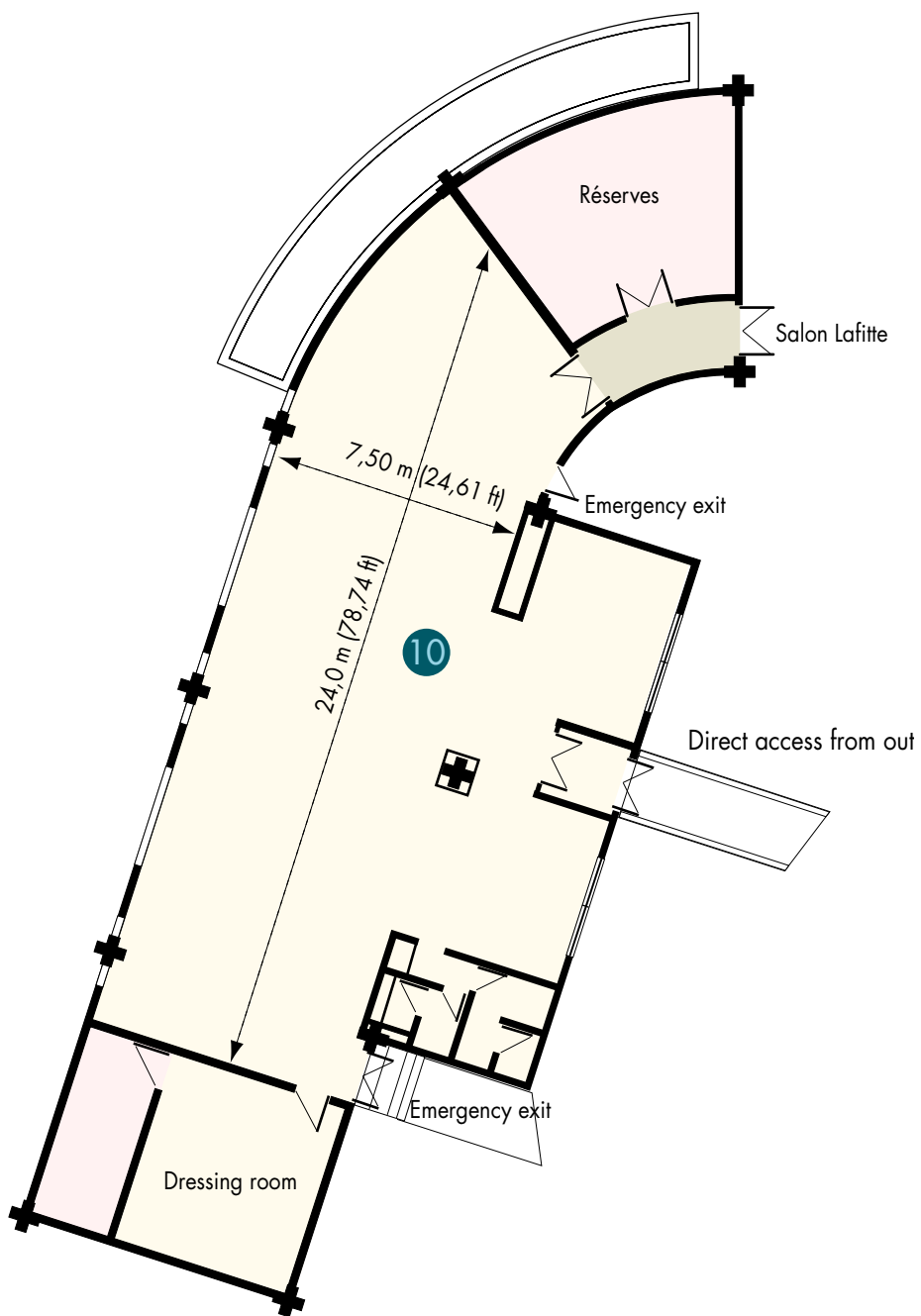



# Panoramique



## Information

Surface (807 sq.ft)	75 m <sup>2</sup>
Height	5,00

## Capacity

Theater style	70
Classroom style	
U-shapped	30
Cocktails	70
Banquets*	35

## Miscellaneous

Sea view & garden view

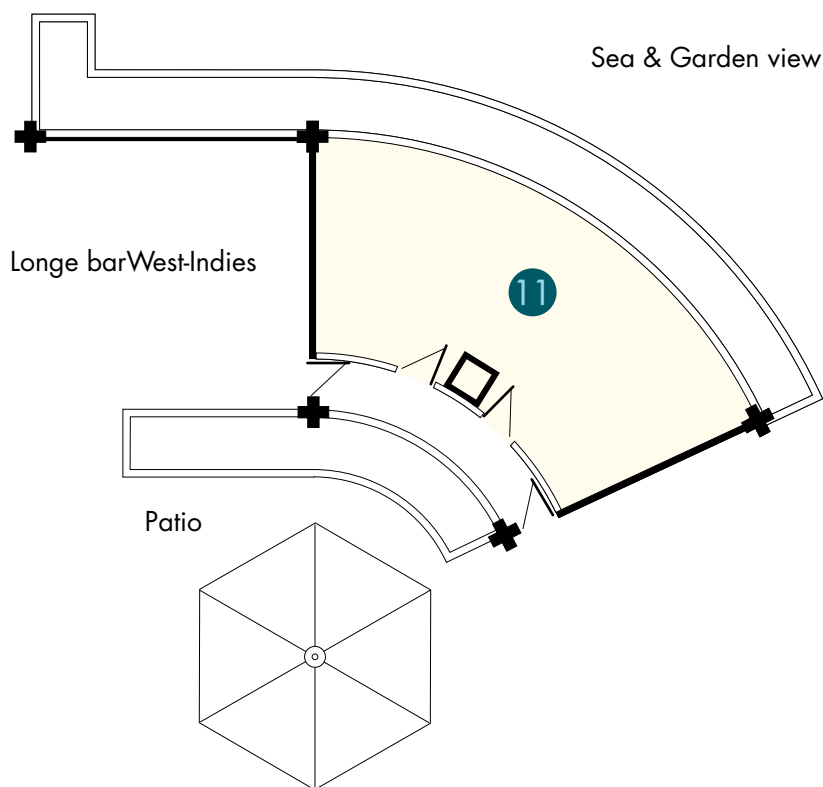



### **Proposals - Guarantees \***

The following proposals are for information only. For supply or quality reasons, we could be under the obligation to modify the content of these proposals, while respecting the equivalences

### **Rates guarantees \***

Our rates and quotations are valid for up to three months from the date of our proposal. After this period, these rates are susceptible to changes, according to economical reasons, the applicable rates will thus be those in effect at the date of the event.

### **Meals guarantees \***

The number of meals to be served must be confirmed at least 48 business hours prior to the event. This number will be used for invoice purposes. When exceeding the number of guests, a supplement will appear on the invoice, on the basis of drinks served.

### **Reservations and methods of payment \***

We will guarantee your reservations up to 20 days prior to the date of your event. After this period, and if we have not received your confirmation, your reservation can be cancelled. Confirmations will only be valid after a minimum payment of 30% of the total of our proposal, the balance outstanding being due at the end of the event.

*\* See our special conditions under contract*





## Food & Beverage

Our hotel can offer a wide variety of food and beverage services :

Buffets (for groups of 50 people and more)

Cocktails with open bar (with or without champagne)

Seminars

Sophisticated menu suggestions

Packages for served apéritif and drinks

Snacks and coffee breaks

Our hotel services remain at your disposal to send you standard proposals or personalized proposals and quotations adapted to your needs.

## Other Services

For your conventions, we can provide the most modern audiovisual material, but for any special request we will send you quotations subject to requests formulated 10 days before the event.

Our hotel services can also arrange excursions and island visits, and entertainment programs.

We can also put you in contact with our decorators and other companies and partners specialized in events and VIP welcome services.





Hôtel La Batelière  
20, rue des Alizés - 97233 - Schœlcher - FWI  
Tél : +596 596 61 49 49 - Fax : +596 596 61 62 29  
<http://www.hotelbateliere.com> - [mice@hotelbateliere.com](mailto:mice@hotelbateliere.com)